

GETTING STARTED



SMSR¹
SIGN MAKING SYSTEM



1 WHAT'S IN THE BOX?



Printer



Quickstart
guide



Power cable &
USB cable



Cutting blades



Squeegee



Dust cover

The above serves as an overview of each item you will find inside this box.
If you somehow notice anything missing please contact: info@rebosystems.com

2 SWITCHING THE MACHINE ON

In order to turn on your SMS-R1 you will need to connect the power cable.

Attention: Do not connect the USB yet



Place the SMS-R1 on
a steady surface



Connect the power cable



Turn your printer ON

LOADING THE SUPPLIES

3 LOADING THE SUPPLIES

In order to start using your SMS-R1 you will need to insert two things:



A Ink ribbon cassette

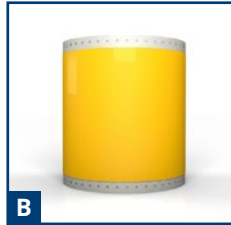

B Printable tape roll

A Loading the ribbon cassette

1. Make sure the cassettes' closed cap is facing you and the open caps are pointing towards the printer
2. Make sure the flat side of the cassette is faced upwards
3. Insert the ribbon cassette from the side of the printer. If you notice any friction please take the cassette out and check if it is correctly positioned

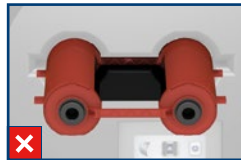

B Loading the tape roll

Attention: Before placing the tape make sure the printer is turned ON and a ribbon cassette is loaded

1. Open the back lid and place the tape roll inside with the printable side up
2. The printer will now detect a tape roll is placed
3. Manually feed the first part of the tape until the printer detects it and starts to automatically feed the rest of the material

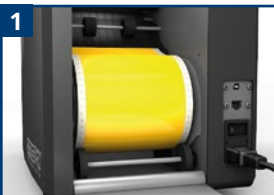

TOUCH SCREEN INTERFACE

4 TOUCH SCREEN CONTROLS & SETTINGS

The built-in touch screen lets the user control the printer and adjust certain settings.

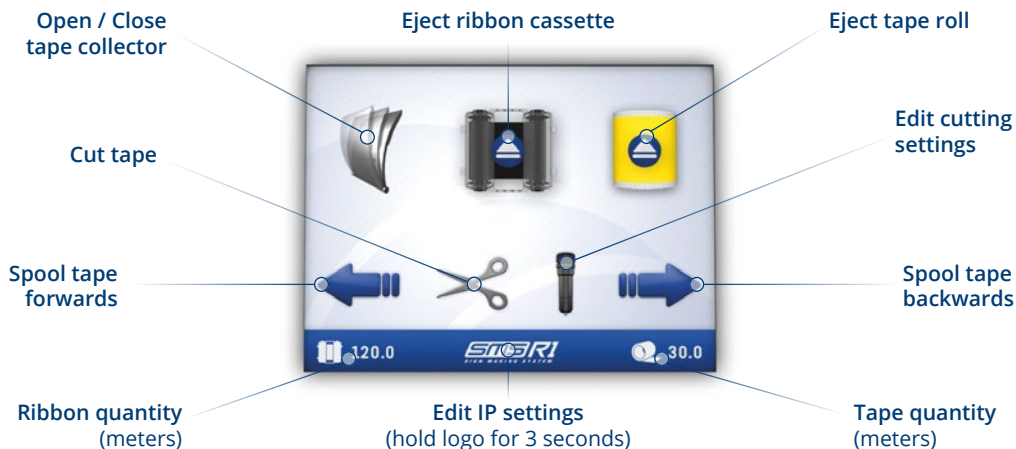

Cutting settings

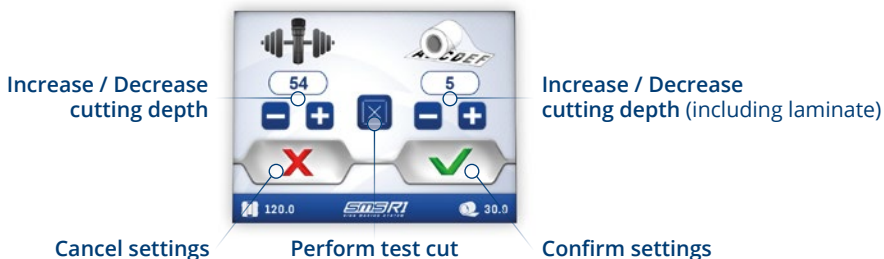

Our tape materials are pre-programmed with the recommended cutting depth settings. You should only change the settings if you notice that the current settings are insufficient.

General IP-settings



Automatic IP-address

Set fixed IP-address

Fixed IP-settings



Input numbers

Confirm / Cancel settings

THE FINAL STEPS...

5 THE FINAL STEPS

Congratulations, the printer is now all setup and almost ready for use.

Visit the start page for drivers, software, instructional videos, label templates & more!

www.SMS-R1.com



Drivers & Tools



Software



Label templates

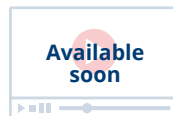

Instructional videos



The manufacturer declares under sole responsibility that this product conforms to the following standards or other normative documents:
EMC: EN 55022:2006+A1:2007, class A
EN 55024: 1998+A1:2000+A2:2003 class B



Rebo Systems certifies that the following products and/or components are compliant with the current requirements of the European Union Restriction and on the use of Hazardous Substances (RoHS) Directive, 2002/95/EC.

SMSR1
SIGN MAKING SYSTEM

© 2020 Rebo Systems (Rebo B.V.). All rights reserved.

Rebo Systems, Rebosystems.com, Rebo.nl, SMS-R1, SMS-R1.com, the Rebo Systems and SMS-R1 logos are registered trademarks of Rebo B.V. Beckeringhstraat 21, 3762 EV Soest (Netherlands)